



What if Beaufort Street...

celebrated its connections?

What if Beaufort street revealed its connections? Celebrated its complexity?

The worry pervades. It leaches out into the air. There is trying too hard – so much signage, signifying a vacancy or desperation not to be, so much clammering for attention. So much tension.

How to get to a comfortable solidity? Take strength from the connections beneath and before, from identity. This place lies on strong ground, with history beyond fragile fashion and fads. Celebrate these connections.

What if an empty window didn't matter because it showed us what came before, what has always been? Not needy, no fear.

What if Beaufort Street gave a glimpse of a transparent place? What if it could show you the earth? Water and dirt beneath, breathing life.

What if Beaufort Street could show you the city? Could show the systems of how we live? See where the stormwater flows. And where it wants to go. The compromise between.

What if we could see where the paths became tracks, then trams and busy bus-ways?

What if you could see into the cafes, the kitchens, the bars? Be together with those people. Who are they?

What if you could see the colours and the textures? Not covered in distraction and cheap perfume.

What if we could see where the birds like to gather, where the Melaleuca and Jarrah need to be?

What if we could see this inhabited place – where people have always moved, have shaped the country? What if we knew the connections? The layers between?

It needs to regain a certainty. The important parts are there – a hill, a hollow, a view of a city. Water moving beneath, people above. A place to see out and be in. Not a needy city. A complex yet confident city. A celebrated and revealed city.

PLACE CONNECTIONS



Sources: (1), (2), (3), (4)

GREEN CONNECTIONS



- Beaufort Street site
- 18m elevation contour
- Historic wetlands
- Current green spaces

Sources: (5), (6), (7), (8)

CITY CONNECTIONS

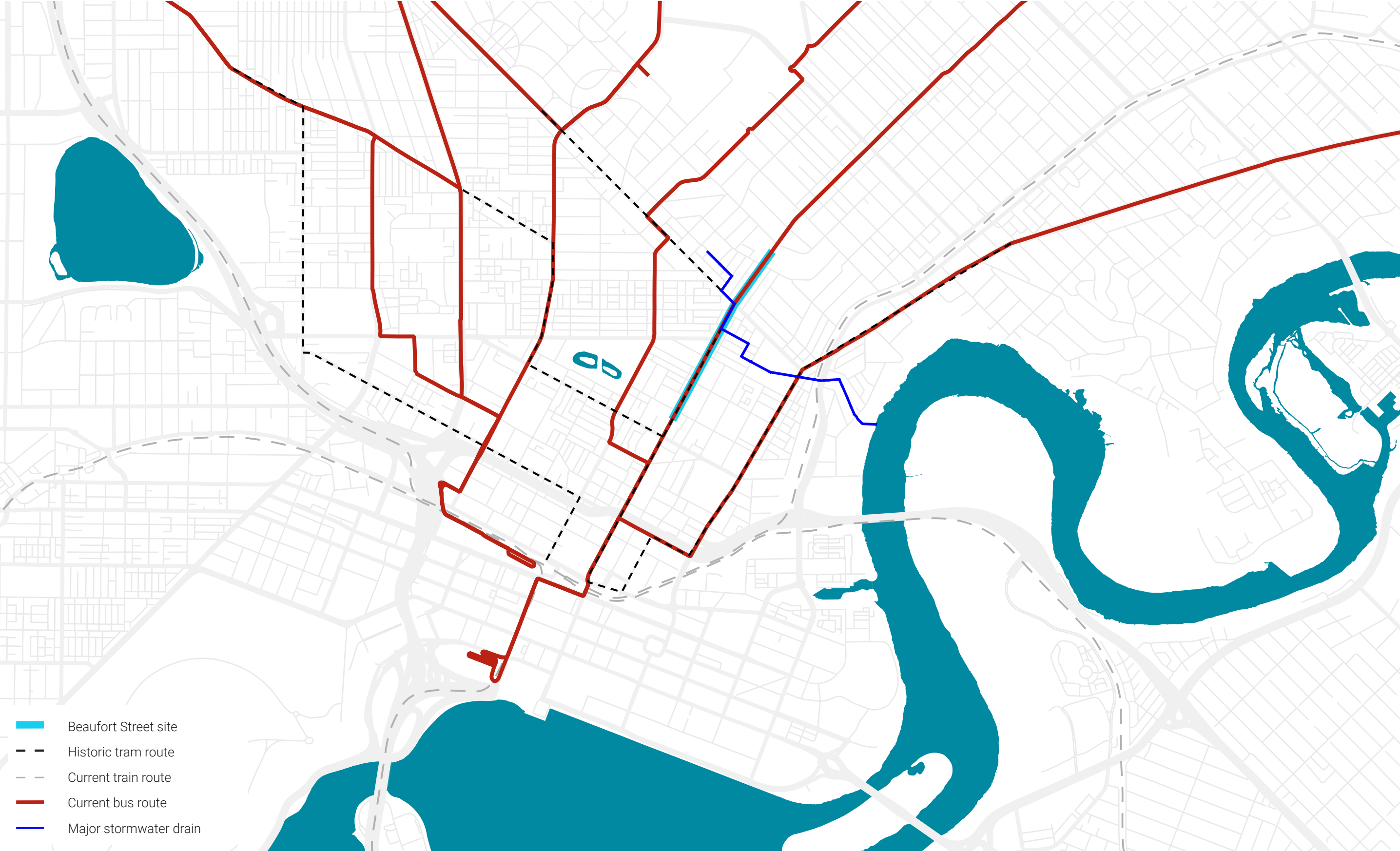

- Beaufort Street site
- Historic tram route
- Current train route
- Current bus route
- Major stormwater drain

Sources: (6), (8), (9), (10)

CONTEXT

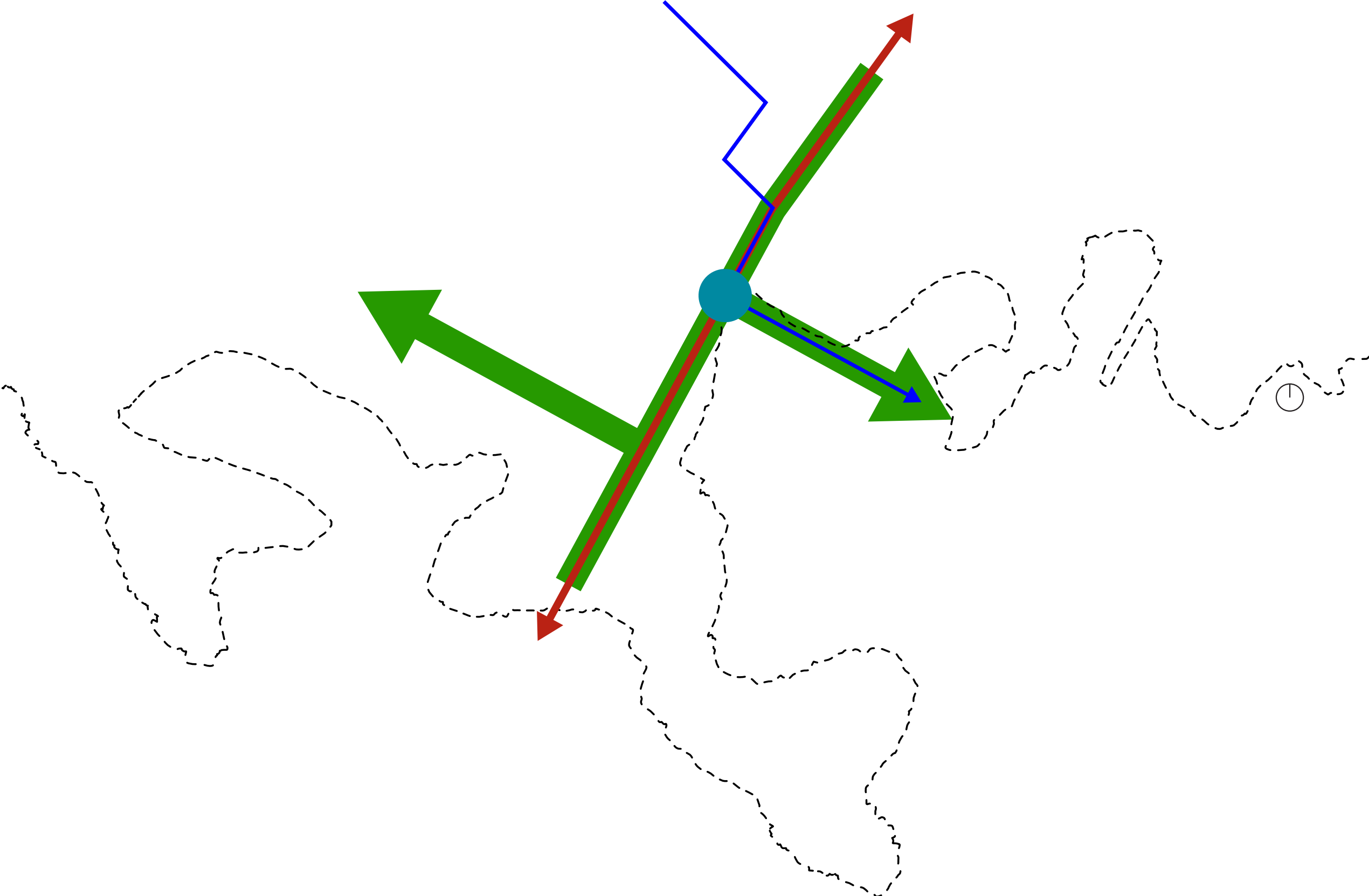

OPPORTUNITIES AND CONSTRAINTS



Sources: (6), (7), (10), (11), (12), (13), (14)

MOVEMENT AND PAUSE



Sources: (16)

*Based on pedestrians counts at 12 locations over two days

**Based on observations over two days

PEOPLE AND THE STREET

"I think businesses need more freedom to extend their space for commerce. It should flow into the street. I think landlords should open up empty lots to startups or young businesses for little rent to remove any 'dead' spots along the street and help activate the street with variety. I also think Alfresco dining would be great like in Northbridge."⁽¹⁵⁾



Not functioning well

Functioning well

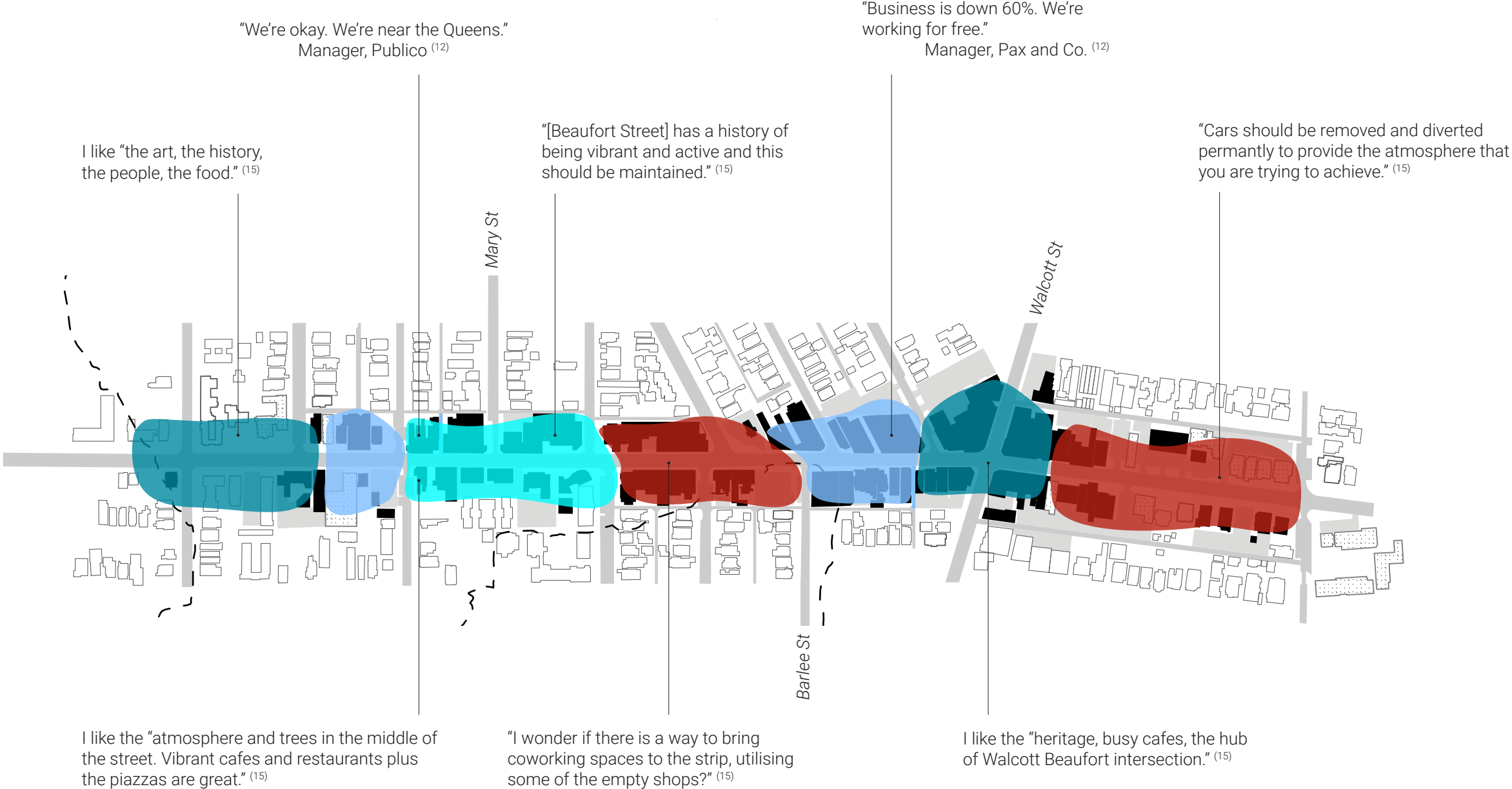

CASE STUDY 1: 5280 TRAIL, DENVER

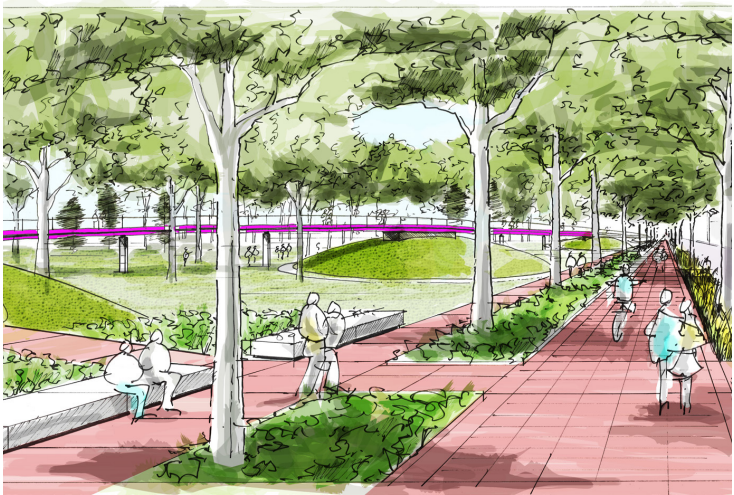
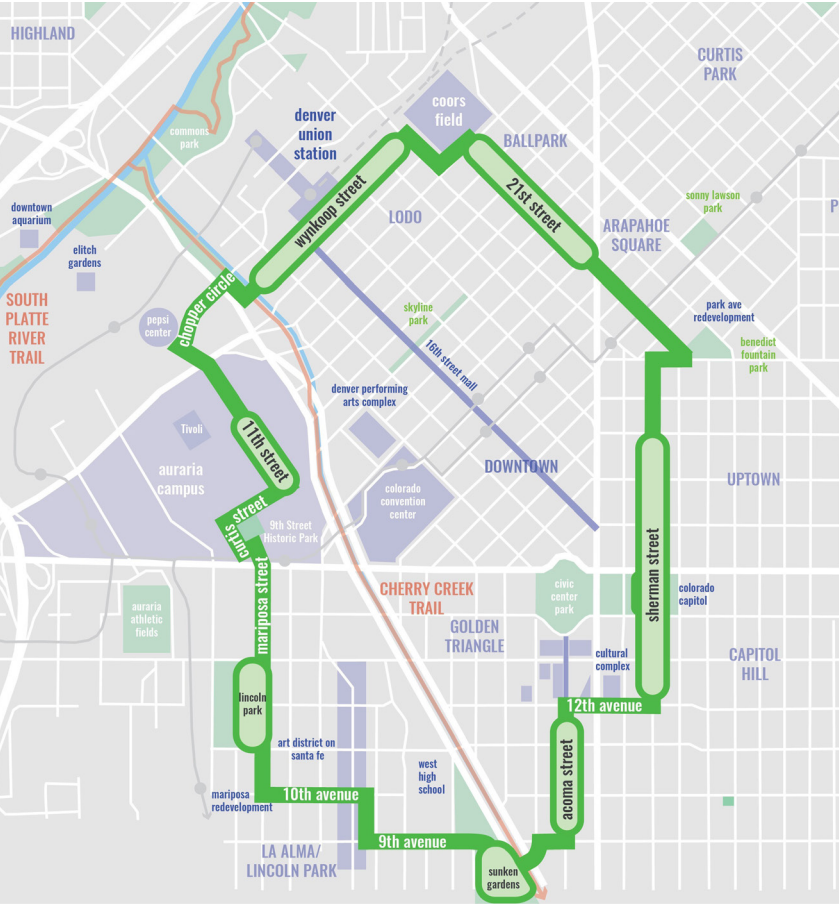

“Prioritizing PEOPLE, HEALTH, CULTURE and NATURE, the 5280 is a new, distinctly Denver amenity, that connects many vibrant and diverse city center neighborhoods through the great urban outdoors, creating a powerful SENSE OF PLACE.”

Downtown Denver Partnership

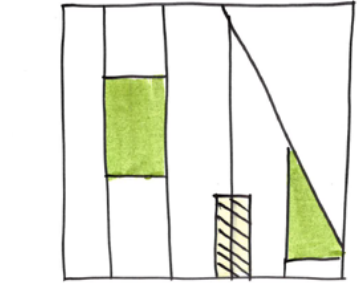
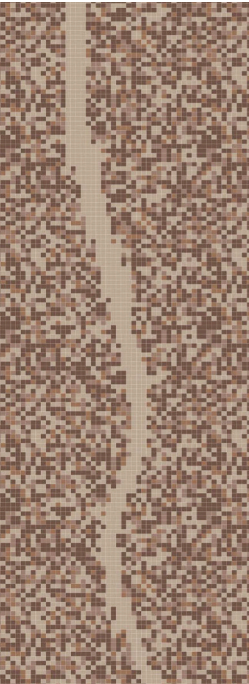
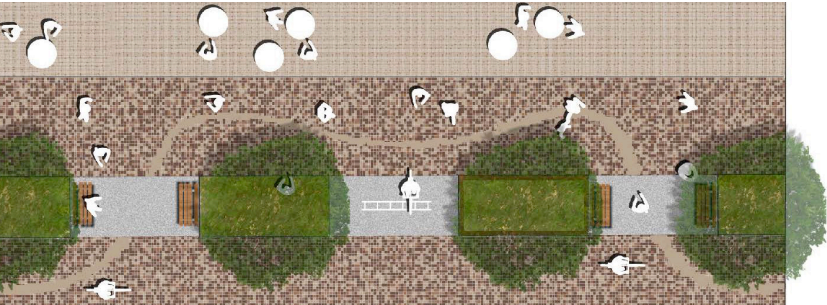

OPPORTUNITY

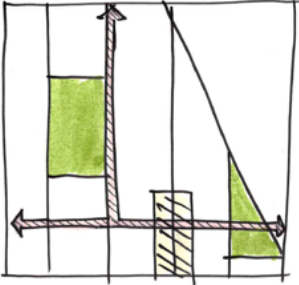

CONNECTION



ENHANCEMENT

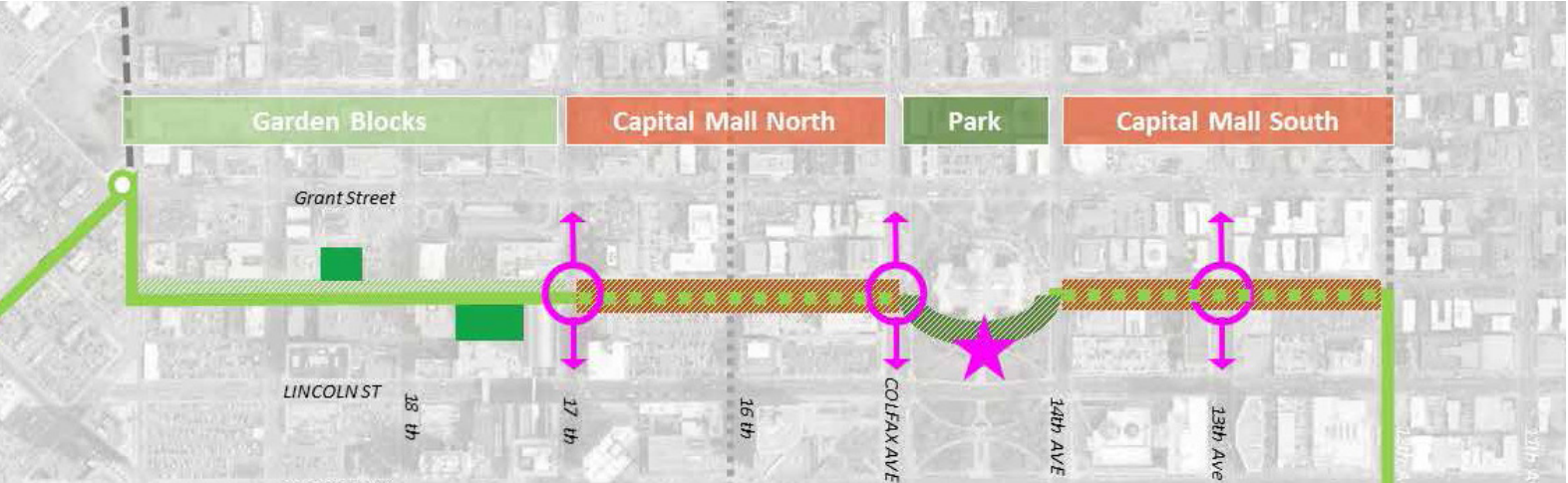

CASE STUDY 2: POBLENOU SUPERBLOCK, BARCELONA

Green spaces Pedestrians Pedestrians and vehicles

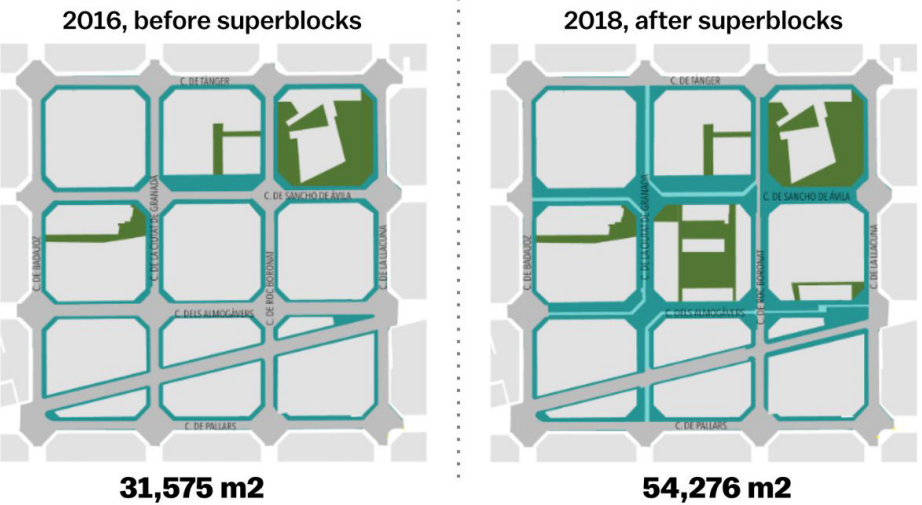

"...a pilot test of a future large-scale strategy for reclaiming public space from private vehicles and making it available for public transport, bicycles and pedestrians."

Ajuntament de Barcelona

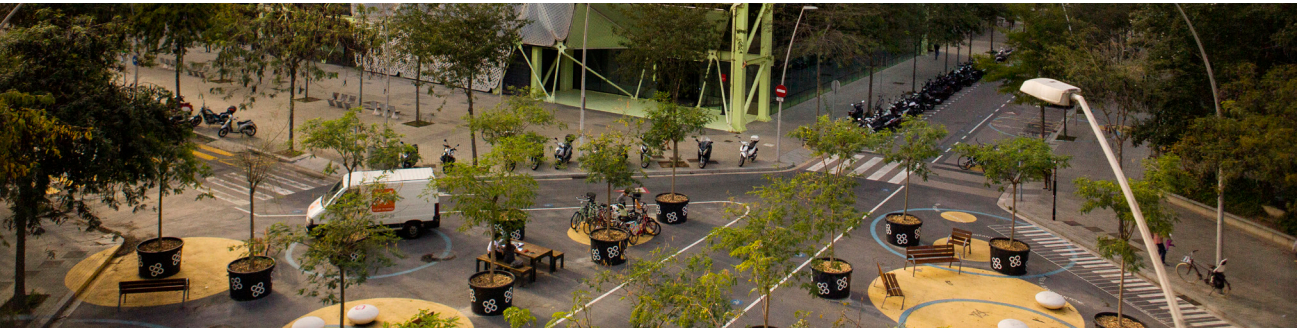

	2016	2018
MOBILIARI URBÀ	36 places per seure	385 places per seure
ZONES DE JOC	0 m2	2.483 m2
ACCESSIBILITAT	99,4%	99,4%
APARCAMENT	575 places 104 places àrea verda veïnat 9 places àrea blava 401 places no regulades 44 places càrrega i descàrrega	316 places 147 places àrea verda veïnat 24 places àrea blava 74 places no regulades 46 places càrrega i descàrrega
ESPAIS VERDS ARBRAT VIARI	9.722 m2 500 unitats	18.632 m2 676 unitats
ACTIVITATS EN PLANTA BAIXA	65 activitats comercials	85 activitats comercials



Sources: (18), (19), (20)

STRATEGIC PLAN

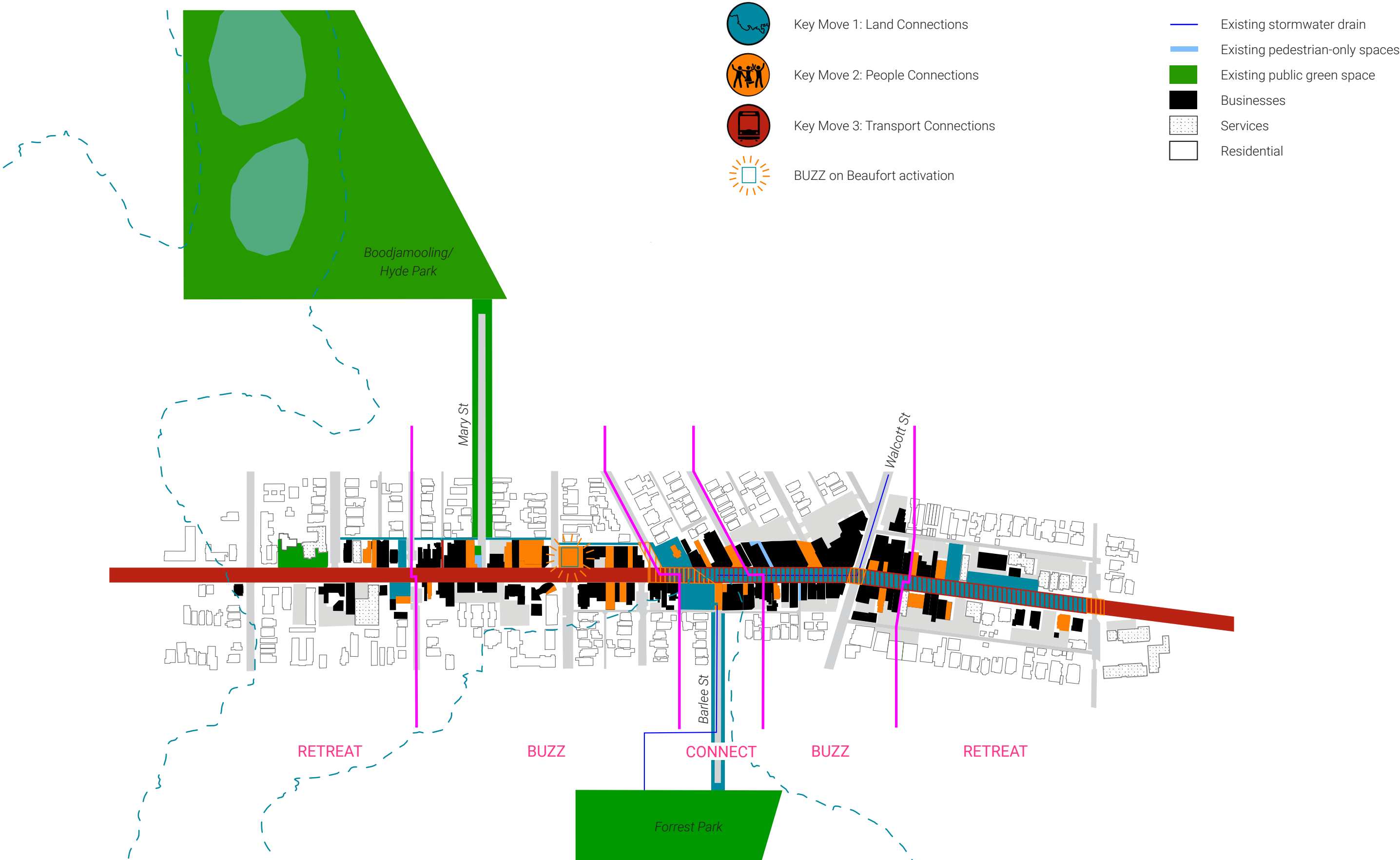

ZONES

BUZZ

- BUZZ on Beaufort
- The Queens, The Flying Scotsman, Astor Theatre, Planet Books
- Restaurants, bars and quirky shops
- Good night lighting
- Co-working/studio and exhibition space in old Empire building
- Pop-up shops open into the night
- Piazzas and lit greened laneways
- Florists
- A place for fun and celebrations of the good things in life

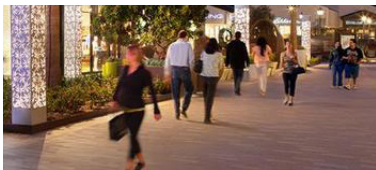

CONNECT

- 18M CONNECT Centre for land and culture information, learning and exhibitions
- 18M CONNECT space with cafes, skate elements and stormwater garden
- 18M CONNECT trail painted on the contour that leads people to and from the surrounding suburbs
- Good night lighting
- Alfresco dining, shopping, street entertainment and small events/markets
- Many public outdoor seating options
- A place for all people to meet and gather

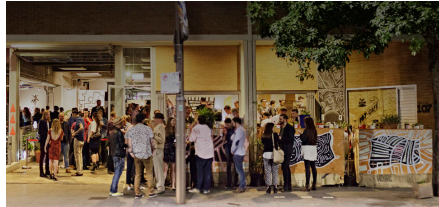
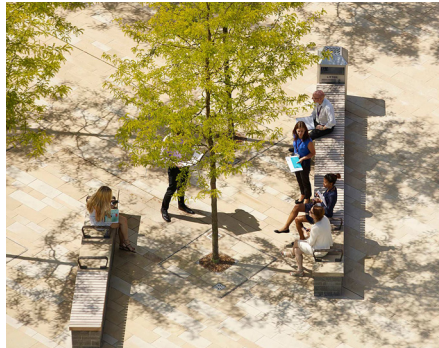
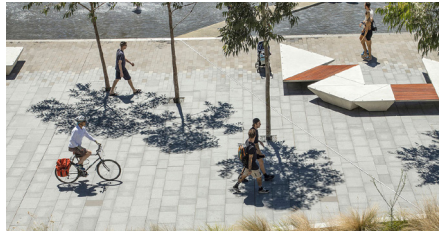





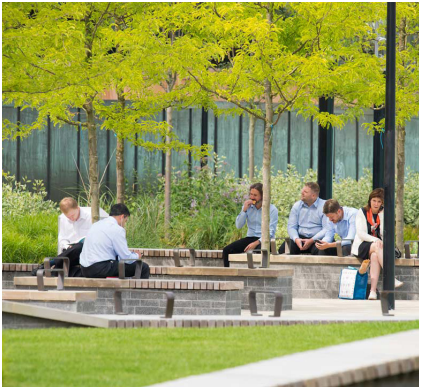

RETREAT

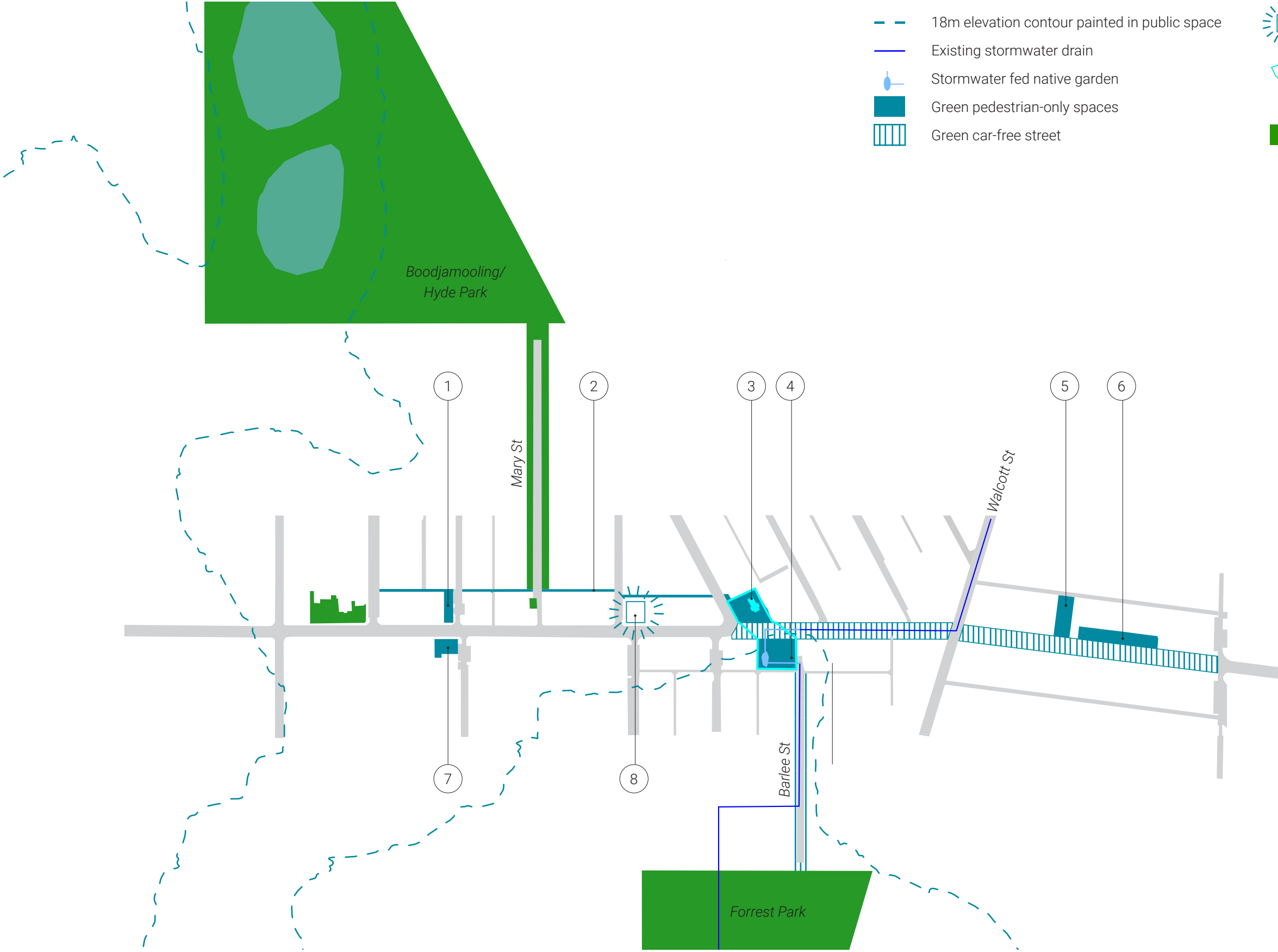

- Community venues for workshops, meetups and play groups
- Child-friendly green public spaces
- Residential areas
- Services and facilities for all
- Easy access and outdoor furniture to provide comfortable public spaces
- A place for residents to interact across generations and find calm on the busy high street



KEY MOVE 1: LAND CONNECTIONS



-  18m elevation contour painted in public space
-  Existing stormwater drain
-  Stormwater fed native garden
-  Green pedestrian-only spaces
-  Green car-free street

-  BUZZ on Beaufort
 -  18M CONNECT space
 -  Existing public green space
- 1 Temporary public-private green space
 - 2 Laneway greened with creepers and planter boxes
 - 3 18M CONNECT land and culture information, learning and exhibition centre
 - 4 18M CONNECT space with local vegetation, large trees and stormwater-fed native garden
 - 5 Public open space with large trees
 - 6 Family-friendly public space with turf and trees
 - 7 Family-friendly green public space with playground
 - 8 Temporary BUZZ activation with planter boxes and creepers (later to be used in laneways)



KEY MOVE 2: PEOPLE CONNECTIONS

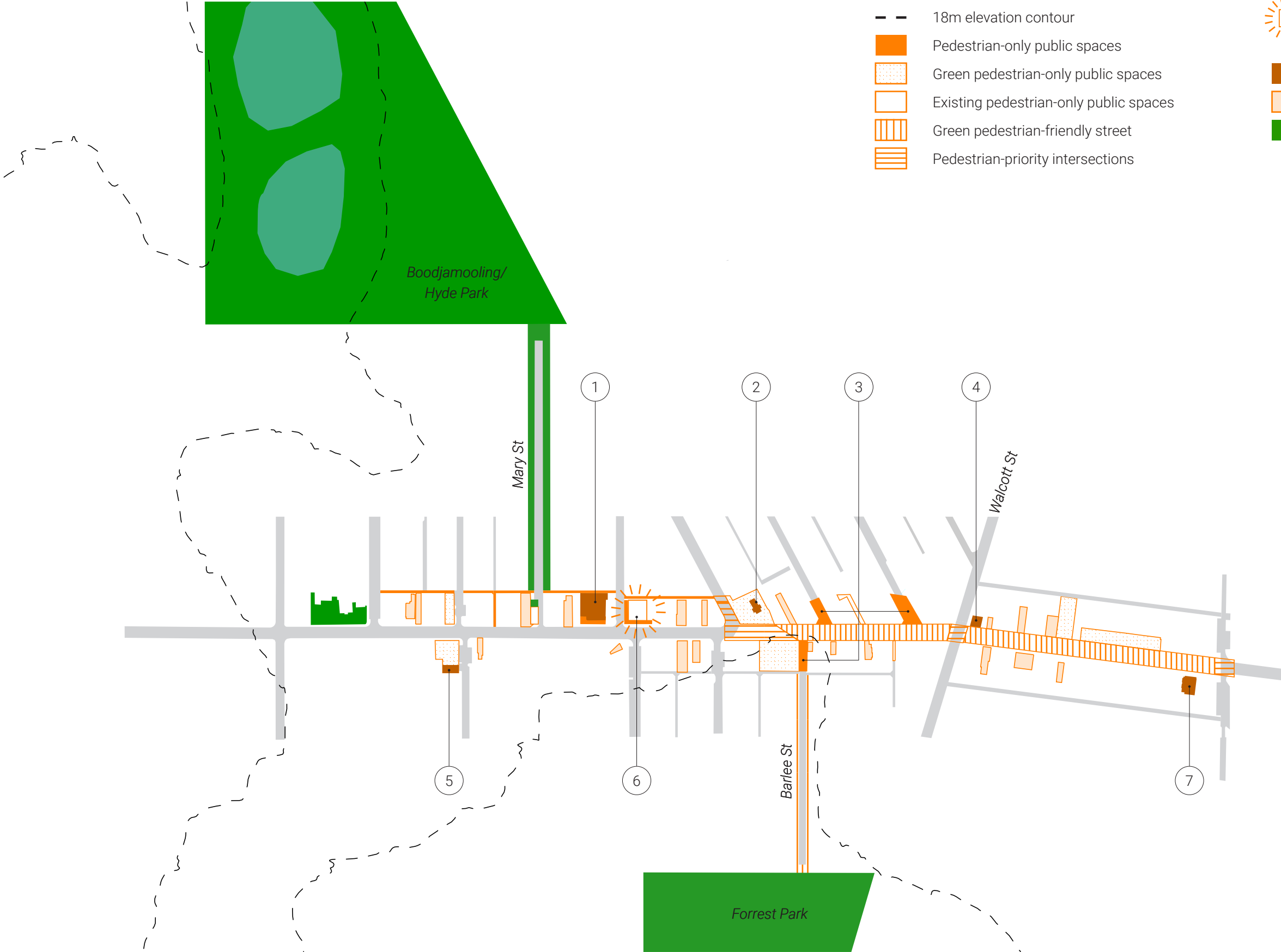

- 18m elevation contour
- Pedestrian-only public spaces
- Green pedestrian-only public spaces
- Existing pedestrian-only public spaces
- Green pedestrian-friendly street
- Pedestrian-priority intersections

- BUZZ on Beaufort
- Co-operative/community spaces
- Pop-up businesses
- Existing public green space

- 1 Co-working studio/business and exhibition space
- 2 18M CONNECT centre for cultural exchange and community
- 3 Pedestrian-only arcades with public seating, shade and alfresco dining
- 4 Astor theatre open to community and school groups for workshops and performances
- 5 Community-run play group
- 6 BUZZ with community workshops and participation
- 7 Community centre for older residents and families with workshops and events



KEY MOVE 3: TRANSPORT CONNECTIONS



- Tram stop
- - 18m elevation contour
- Wireless tram tracks
- Street Type 1: car and tram, and separate bike lanes
- ▨ Street Type 2: shared tram, bike and pedestrian street

- ▨ Pedestrian-priority intersections
- Pedestrian-only public spaces
- ▨ Pedestrian-friendly street
- Existing pedestrian-only public spaces
- Existing public green space

- 1 Zebra crossing
- 2 Button request pedestrian and tram-priority traffic lights/crossing



CAR TRAFFIC CHANGES

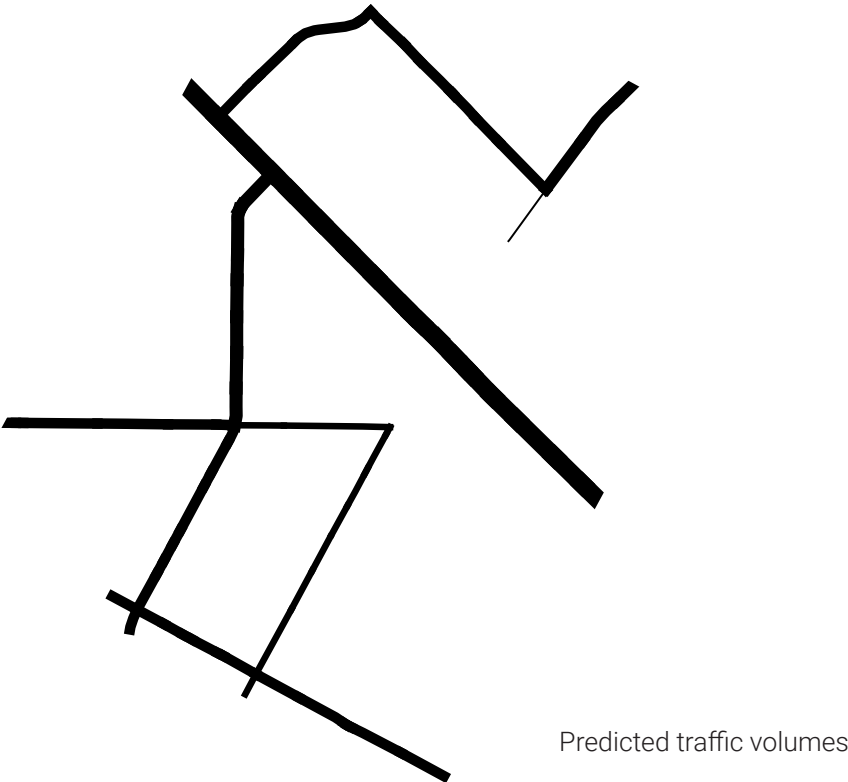
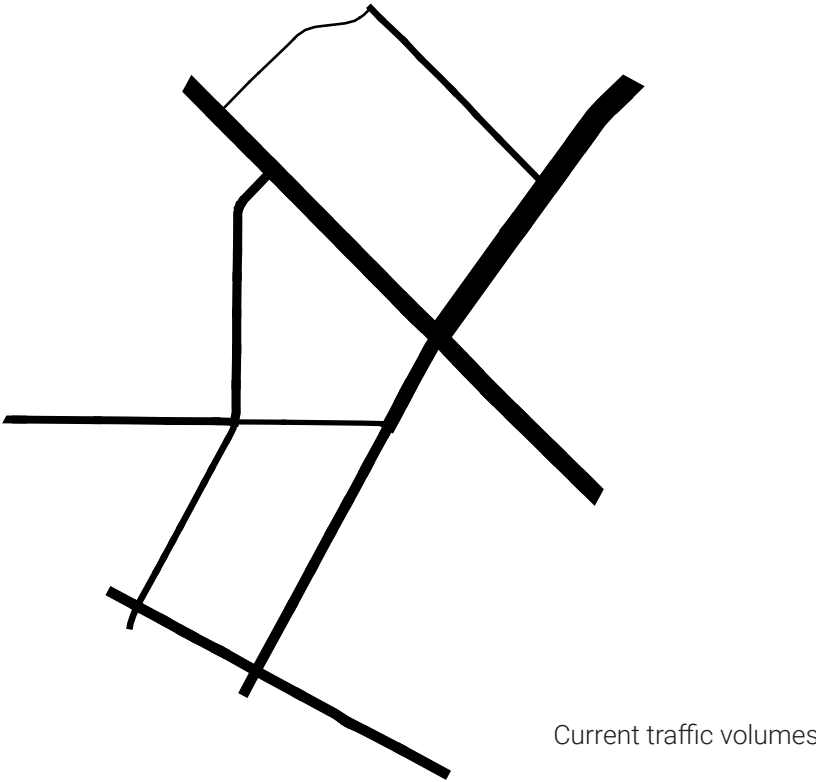

Sources: (21)

MOVEMENT AND PAUSE CHANGES

Total pedestrian counts*

- < 500 people
- 1000 - 1500 people
- > 1500 people

- Car parks <50% used**
- Car parks >50% used**

- Car parks not observed
- Anchor businesses
- Under-used car parks converted to green POS
- Under-used car parks converted to piazza
- Highest people counts

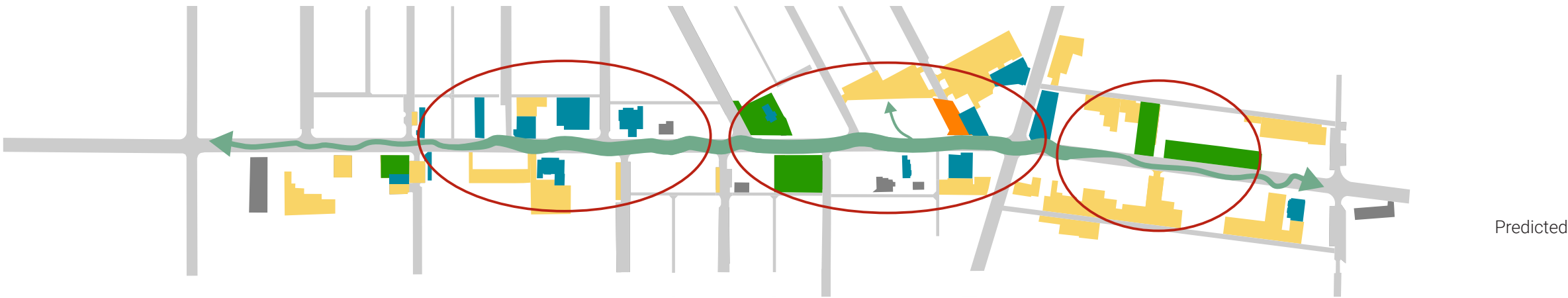
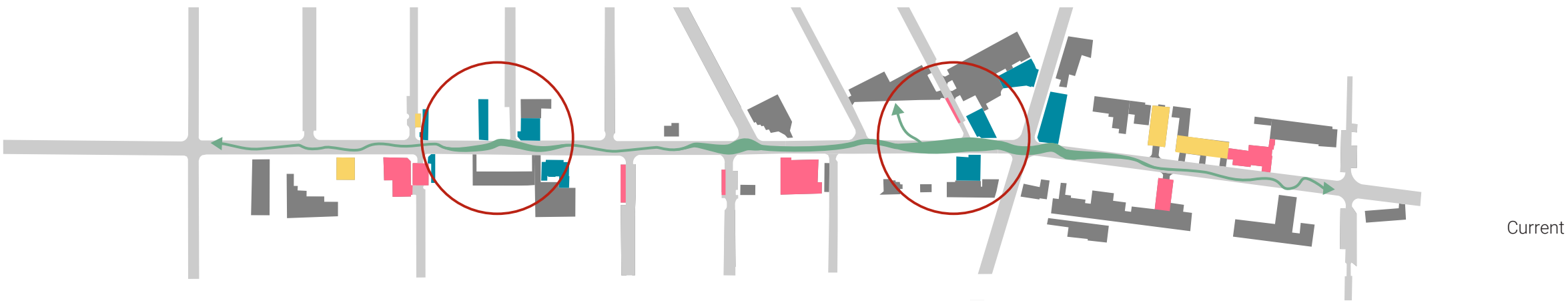

Source: (16) *Based on pedestrians counts at 12 locations over two days **Based on observations over two days

IMPLEMENTATION STAGES

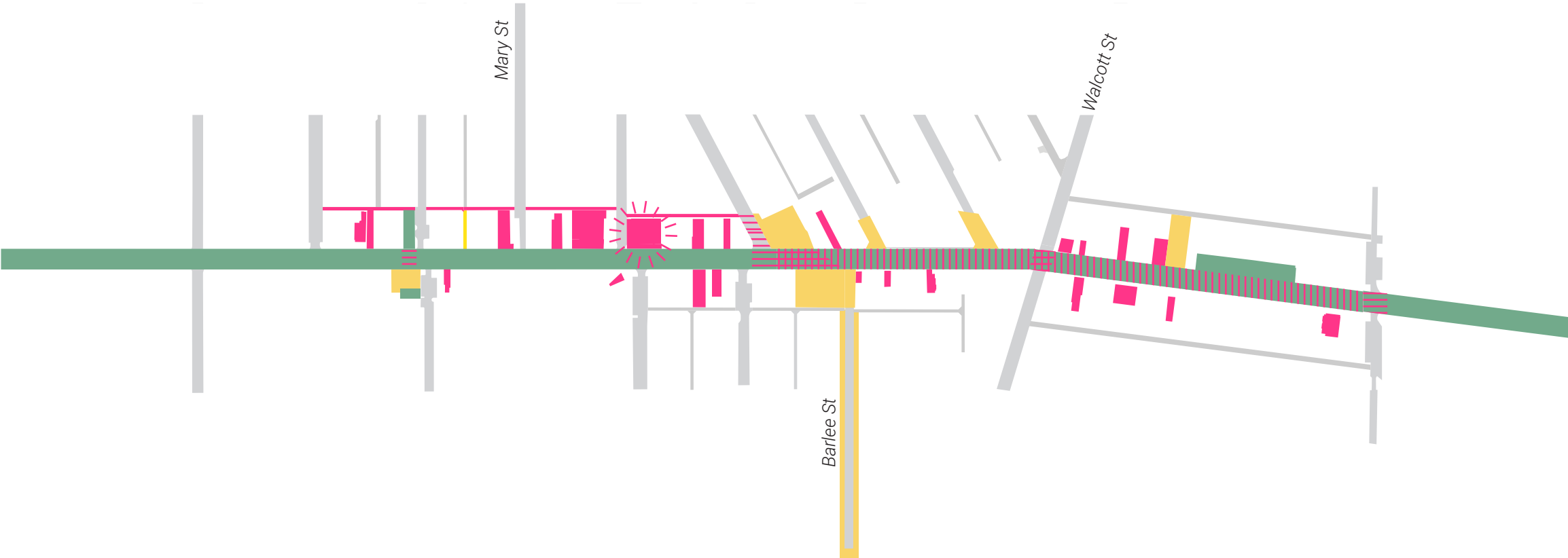

STREET TYPE 1



Dual direction shared wireless tram and car lanes

Alfresco dining on wide pavements

Dedicated bike lane with raised areas at tram stops

Dedicated bike lane with raised areas at tram stops

Slim shade awnings with no advertising



| 4.9 m | 1.5 m | 7.2 m | 1.5 m | 4.9 m |

STREET TYPE 2



Shared wireless tram, bike and pedestrian street

Slim shade awnings with no advertising

Street all at one level except raised tram stops

Dense tree corridor

Large areas for alfresco dining, shop product display and street furniture



6.7 m

6.6 m

6.7 m

18M CONNECT SECTION

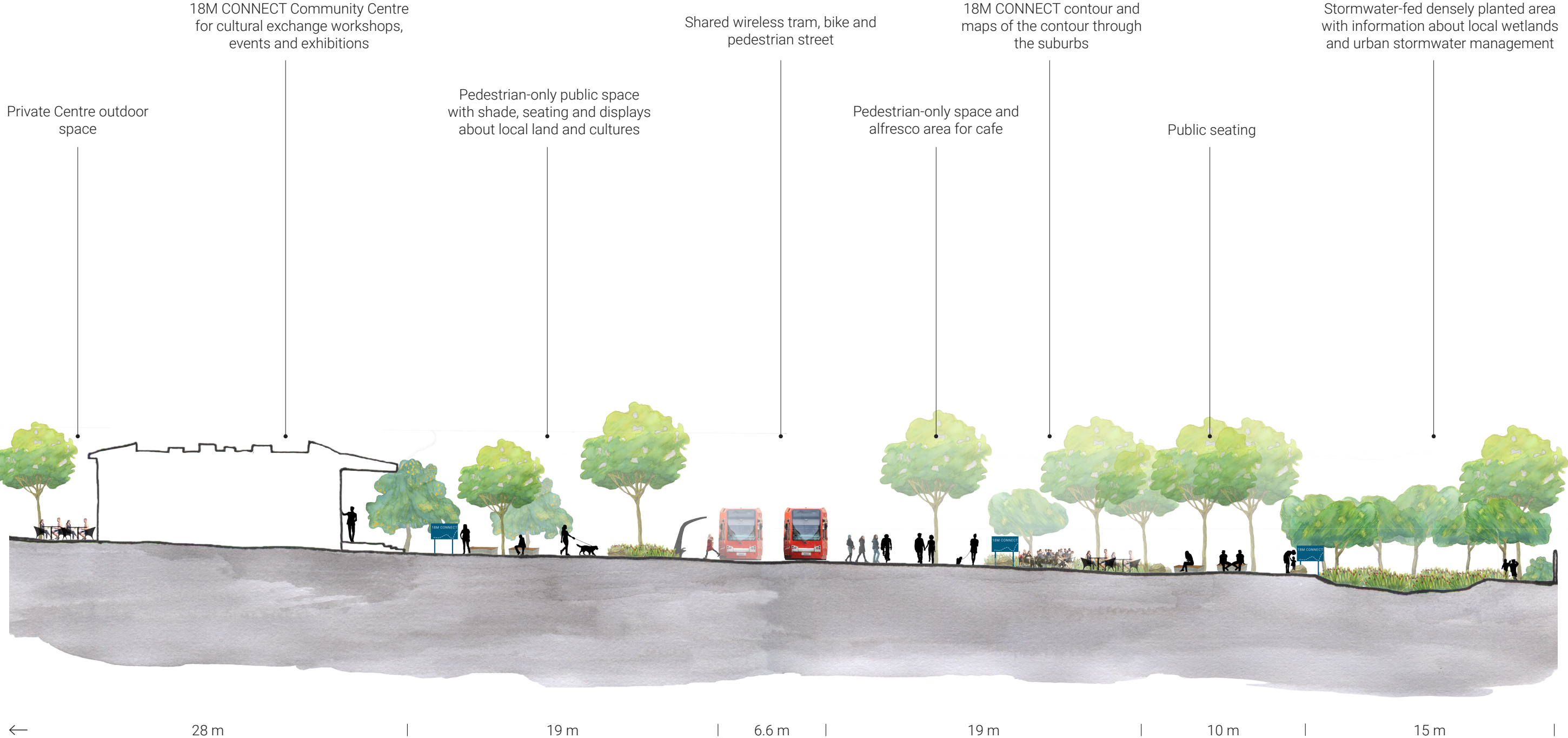
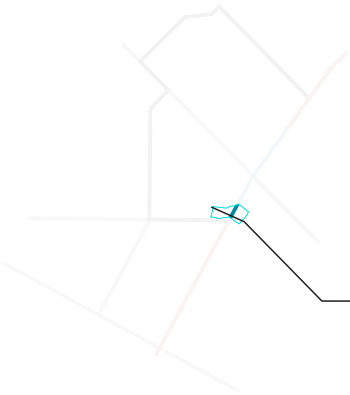

18M CONNECT



BUZZ STREET



MODEL



REFERENCES

- (1) DLGSC, 2019. Gnarla Boodja Mili Mili. <https://gnarlaboodjamap.dlgsc.wa.gov.au/#/home>
- (2) Pat Forster, 2018. Noongar place names Swan -Canning Estuary and Environs. <https://patforsterblog.files.wordpress.com/2018/02/noongar-placenames-without-downloaded-images.pdf>
- (3) Dept. of Env., 2005. Study of Groundwater-related Aboriginal Cultural Values on the Gngangara Mound, Western Australia.
- (4) DMIRS, 2019. 1:50 000 Surface Geology. <https://dasc.dmp.wa.gov.au/dasc/>
- (5) SRO, 2015. Plan of Perth Township showing Lots, Streets & Lakes from Mt Eliza in West to Walters & Claise Brooks in East, Lakes Henderson & Poulett to North & St Georges Terrace in South. Unsigned, probably Hillman, 1838. <https://archive.sro.wa.gov.au/index.php/perth-18a-plan-of-perth-township-showing-lots-streets-lakes-from-mt-eliza-in-west-to-walters-claise-brooks-in-east-lakes-henderson-poulett-to-north-st-georges-terrace-in-south-unsigned-probably-hillman-1838-scale-6-chains-to-an-inch-28>
- (6) Landgate, 2019. Various datasets. <https://data.wa.gov.au/>
- (7) Nearmaps, 2019. Aerial photograph. <https://www.nearmap.com/au/en>
- (8) PTA, 2019. Public Transport Authority Service Routes. <https://catalogue.data.wa.gov.au/dataset/public-transport-authority-services-bus-routes>
- (9) Ian Playdell, 2019. Perth Historic Tram Network Map. Handout at: <https://www.eventbrite.com.au/e/electric-transport-in-vincent-tickets-64217942595>
- (10) Water Corporation, 2019. Drainage Gravity Pipe. <https://catalogue.data.wa.gov.au/dataset/drainage-gravity-pipe>
- (11) Pink Team, 2019. LACH 4424 Phase 2 Site Analysis.
- (12) Yellow Team, 2019. LACH 4424 Phase 2 Site Analysis.
- (13) Green Team, 2019. LACH 4424 Phase 2 Site Analysis.
- (14) Orange Team, 2019. LACH 4424 Phase 2 Site Analysis.
- (15) Beaufort Street Network, 2019. Brighter Beaufort Action Plan Community Response Data.
- (16) LACH 4424 Class, 2019. Jan Gehl Study - Pedestrian, Stationary and Car Park Counts.
- (17) Downtown Denver Partnership, 2019. 5280 Trail Vision Plan and Design Guidelines. <https://www.downtowndenver.com/initiatives-and-planning/the-5280/>
- (18) Public Space, 2018. Poblenou "Superblock". <https://www.publicspace.org/works/-/project/k081-poblenou-s-superblock>
- (19) Vox, 2019. Barcelona wants to build 500 superblocks. Here's what it learned from the first ones. <https://www.vox.com/energy-and-environment/2019/4/9/18273894/barcelona-urban-planning-superblocks-poblenou>
- (20) Ajuntament de Barcelona, 2018. Amb la Superilla, el Poblenou ha guanyat més de 25.000 metres quadrats d'espai per a les persones. https://ajuntament.barcelona.cat/santmarti/ca/noticia/amb-la-superilla-el-poblenou-ha-guanyat-mes-de-25-000-metres-quadrats-despai-per-al-ciutada_714967
- (21) Main Roads WA, 2019. Traffic Map. <https://trafficmap.mainroads.wa.gov.au/map>